

# ADD A BORDER (STROKE)

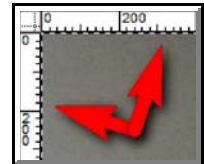
© Darry D Eggleston, 813.677.2871, [DarryD@darryd.com](mailto:DarryD@darryd.com)

Click on any blue, underlined text to go to its linked reference.

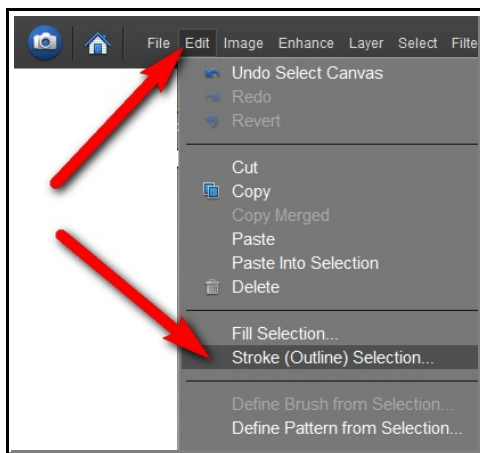


Here is a way to add a simple border to any photo.

1. With the image in the Editor, use the Ctrl+A key to select all. You'll see "marching ants" along the border (**Figure 1**).

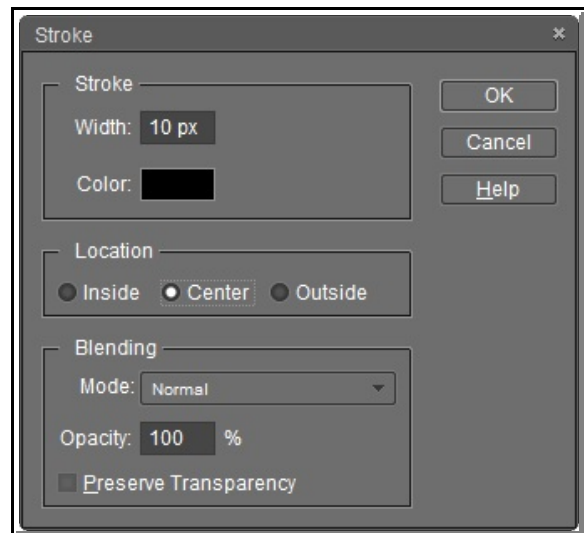


**Figure 1**



**Figure 2**

2. From the MenuBar, select Edit ► Stroke (Outline) Selection (**Figure 2**).



**Figure 3**

3. Set the Stroke (**Figure 3**):

- ① Set the Width to 10 pixels.
- ② Set the color to the desired color by Left-clicking on the Color "box".
- ③ Set the Location to Center.
- ④ Left-click on "OK" button.

4. SAVE your work by using either the *Ctrl + S* keys, or select *File > Save* from the MenuBar.

---

<sup>1</sup> Editors: Peggy S. Eggleston, Dick Evans & Parker Monroe. Permission for reproduction in whole or in part is granted to individuals and to organizations for internal, non-profit use provided credit is given to the author along with the copyright notice: Article reprinted with permission. Copyright © 2008 Darry D Eggleston, <http://DarryD.com>.