

ADD A BORDER (SELECT)

© Darry D Eggleston, 813.677.2871, DarryD@darryd.com

Click on any blue, underlined text to go to its linked reference.



Here is a way to add a complex border to any photo. It requires more steps than my lesson, “*Add a Border (Stroke)*,” but offers much more options for exotic results.

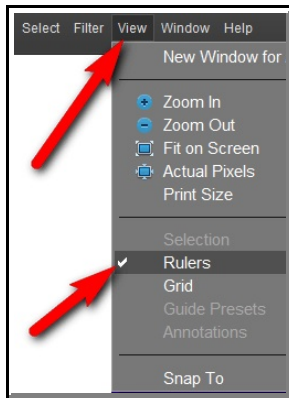

Figure 1

1. With your photo in the Editor, ensure you can see the Rulers by selecting View ► Rulers from the MenuBar (**Figure 1**).

2. I prefer to work with the Rulers set to inches. If yours is not showing inches, change to inches (**Figure 2**):

- ① RIGHT-click on the Rulers.
- ② Left-click on “Inches”.

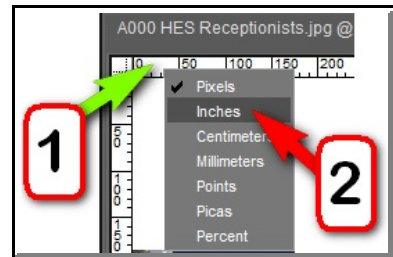

Figure 2

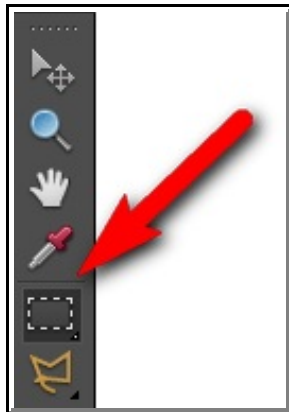

Figure 3

3. Select the Rectangular Marquee tool (**Figure 3**).

¹ Editors: Peggy S. Eggleston, Dick Evans & Parker Monroe. Permission for reproduction in whole or in part is granted to individuals and to organizations for internal, non-profit use provided credit is given to the author along with the copyright notice: Article reprinted with permission. Copyright © 2008 Darry D Eggleston, <http://DarryD.com>.

4. Draw your selection (**Figure 4**) by Left-clicking the desired distance from the left, upper corner, holding down the button, and dragging your cursor to the lower, right corner.

5. Since the selection is *inside* the dotted rectangle, but the border is to be *outside* the selection, from the MenuBar, choose Selection Inverse (**Figure 5**).

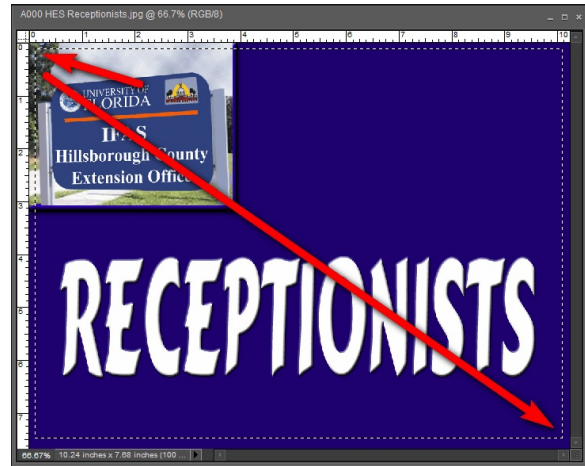

Figure 4

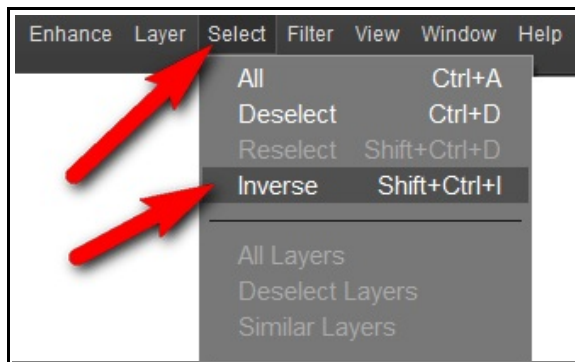

Figure 5

6. Now you'll see a dotted border along the edges (**Figure 6**).

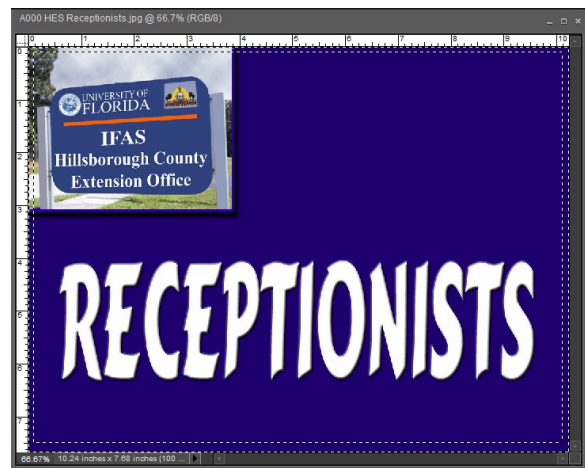

Figure 6

7. Create a New Layer (**Figure 7**) by Left-clicking on the icon to the upper-left in the Layers palette.

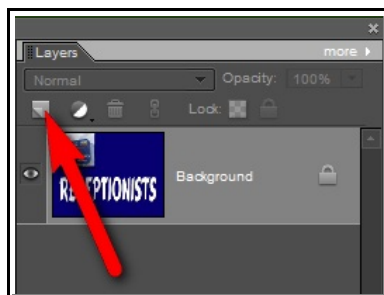

Figure 7

8. The New Layer appears in the Layers palette (Figure 8).



Figure 9

9. Select Paint Bucket (Figure 9). You'll see that I'm using Black as the color of the fill, but it doesn't matter what color you use. The color will be changed later.

10. Left-click on the selected area (Figure 10) to fill it with the color.

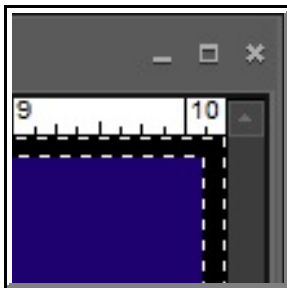

Figure 11

11. You now have a black-filled border (Figure 11).

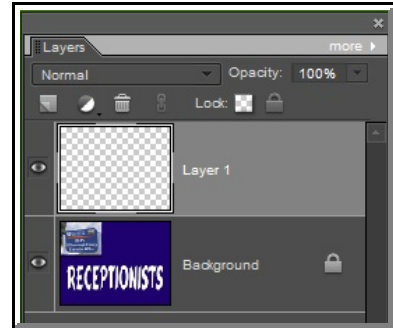

Figure 8

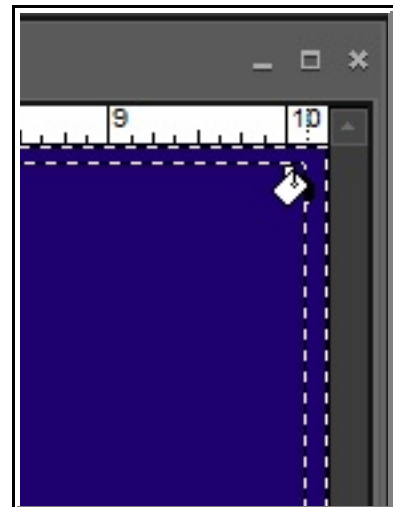

Figure 10

12. Click on any of the selections in the Effects palette. I have selected “Star Glow” (**Figure 12**).

If your Effects palette is not visible, Left-click on Window ► Effects from the MenuBar.

13. The result is a beautiful Star Glow border (**Figure 13**).

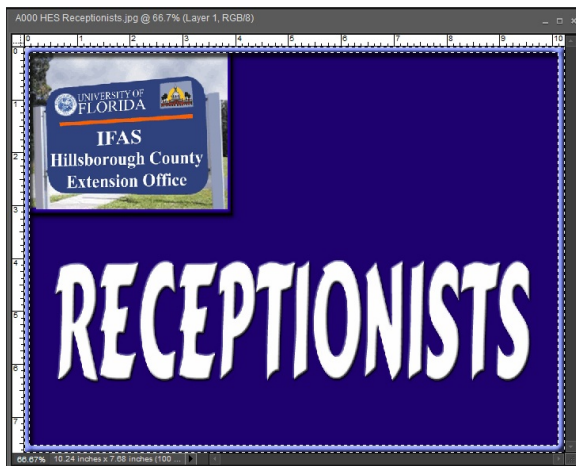

Figure 13

15. Flatten the Layers (**Figure 14**):

- ① Left-click on “more”.
- ② Left-click on “Flatten Image”.

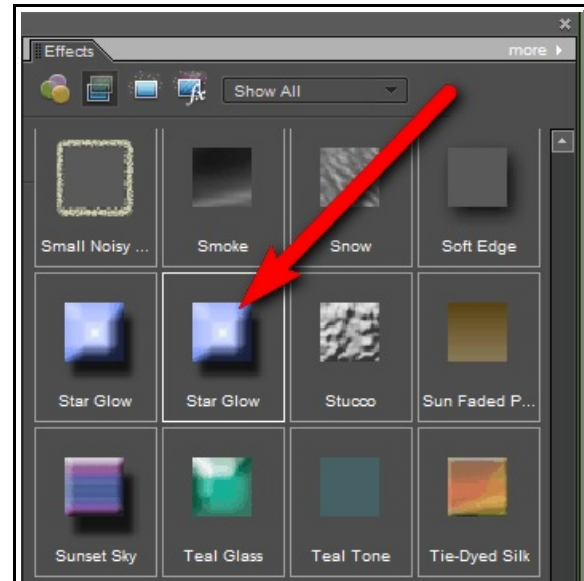

Figure 12

14. Use the Ctrl+D keys to deselect (remove) the marching ants from around the border.

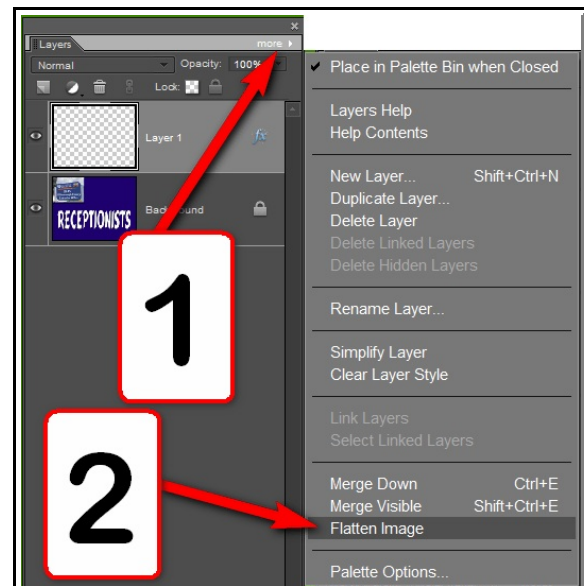

Figure 14

16. **SAVE** your work by using either the *Ctrl + S* keys or, from the MenuBar, select *File > Save as*.

17. Ensure that the “Image Options” is set at the Maximum quality (**Figure 15**), then Left-click on “OK” button.

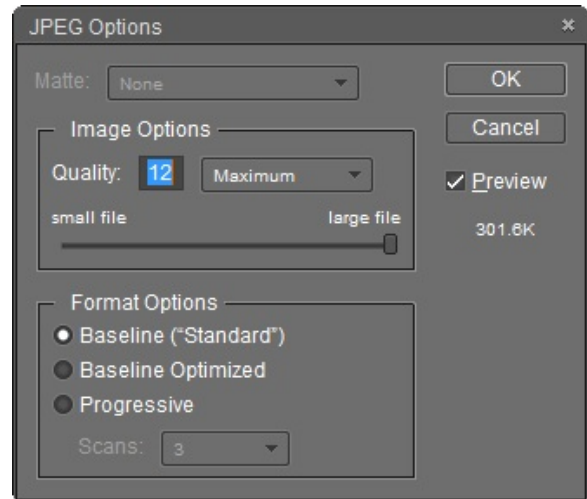

Figure 15